

SEC:A-A

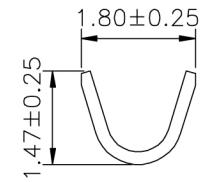

SEC:B-B

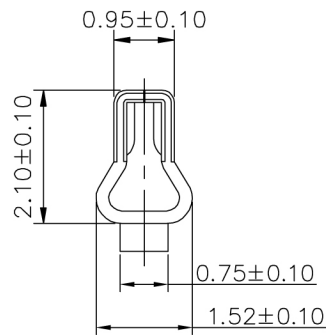

**SPECIFICATIONS**

Current Rating: 2A AC,DC  
 Voltage Rating: 300V AC,DC  
 Withstanding Voltage: 1000V AC/minute

**Ordering Information & Specifications**

Part No.	Wire Range	Insulation O.D.	Material	Finish	Qty/reel
CAE-T20	AWG#24-#28	1.50mm(max)	Phosphor Bronze	Tin-plated	10,000pcs

Note:e-Stamping before Tin-plated

所有材料為  
 "環保材料"  
 2014.1.20  
 RoHS

DESCRIPTION(內容):	DRAWN(製圖): Larry	GENERAL TOLERANCE: (公差)	REV: R0	REV	DESCRIPTION	DATE
				R0		
Pitch 2.0mm Terminal	CHECKED(確認): MANDY	.X ±0.25 .XX ±0.15 .XXX ±0.05	UNIT: mm	R1	RELEASE	2014.01.17
	PART NO: (料號) CAE-T20	SCALE(比例): FREE	SIZE: A4	R2		
	DWG NO(圖號): A2100-TPe	APPROVAL(核准): JOHNNY	⊕	SHEET: 1/1	R3	