

P. C. B Hole Layout

SPECIFICATIONS

Current rating	:1A AC, DC
Voltage rating	:125V AC, DC
Temperature range	:-25° C~+85° C
Contact resistance	:20mΩMax
Insulation resistance	:100MΩMin
Withstanding voltage	:500 V AC/minutePin
Material	:Copper Alloy
Finished	:Tin-plated
Housing Material	:Nylon-6T, UL94 V-0
Color	:Beige

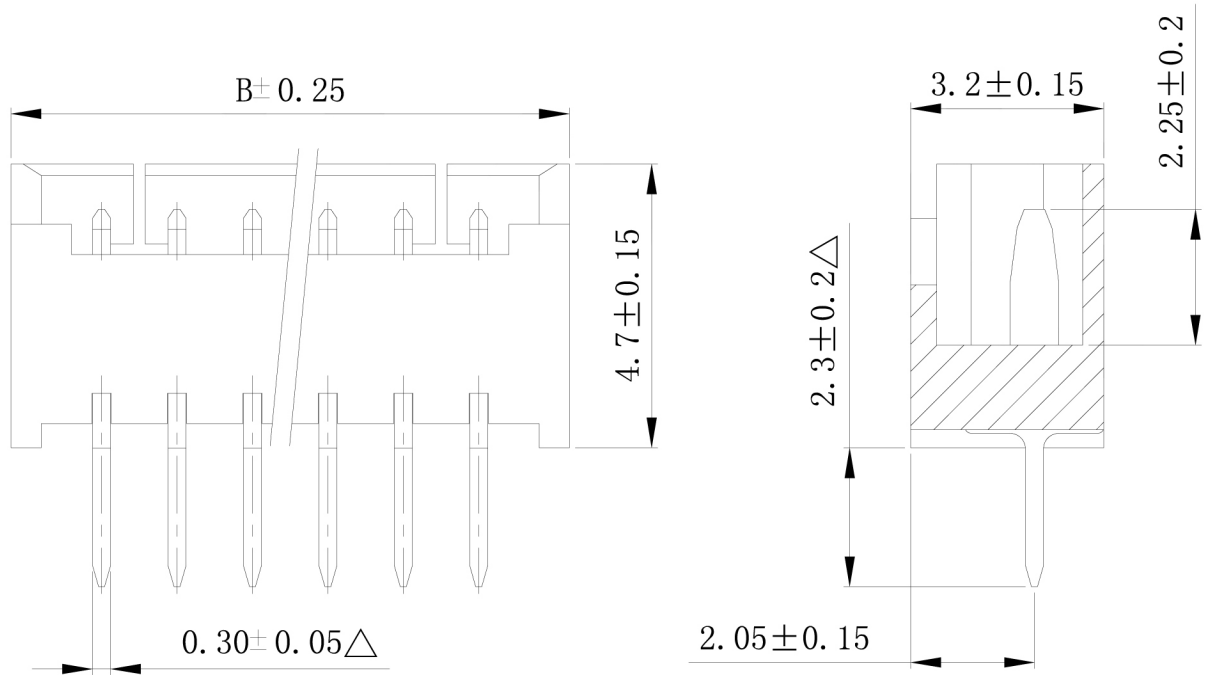

Ordering Information & Dimensions

Part No.	Dimensions	
	A	B
CCX-W125-02-DIP	1.25	4.25
CCX-W125-03-DIP	2.50	5.50
CCX-W125-04-DIP	3.75	6.75
CCX-W125-05-DIP	5.00	8.00
CCX-W125-06-DIP	6.25	9.25
CCX-W125-07-DIP	7.50	10.50
CCX-W125-08-DIP	8.75	11.75
CCX-W125-09-DIP	10.00	13.00
CCX-W125-10-DIP	11.25	14.25
CCX-W125-11-DIP	12.50	15.50
CCX-W125-12-DIP	13.75	16.75
CCX-W125-13-DIP	15.00	18.00
CCX-W125-14-DIP	16.25	19.25
CCX-W125-15-DIP	17.50	20.50

DESCRIPTION(內容): 1.25mm Wafer 180° (環保材料)	DRAWN(製圖): 黃炳秋	GENERAL TOLERANCE: (公差) .0 ±0.20 .00 ±0.15 .000 ±0.10	REV: A/9	REV	DESCRIPTION	DATE
	CHECKED(確認):		UNIT: mm			
PART NO: (料號) CCX-W125-XX-DIP	APPROVAL(核准):	SCALE(比例): 1:XX	SIZE: A4	2	(3C)尺寸2.2變更為2.3	2007.08.15
DWG NO(圖號):			SHEET: 1/1	3	料號由: CX-W125-XX-DIP 五金材質: 磷青銅改為黃銅	2008.01.30 2008.04.11
				9	增加尺寸	2013.07.08